

09K Small Straight Gate Instruction Manual



Read this Instruction manual before use.

Using this device without understanding this products' operation and care may lead to injury.

If you do not understand how to use this product and do not receive proper training, DO NOT use this product. Call your distributor for more information.



75 Highland Dr.
Putnam, CT 06260

T: 800-420-4673
F: 800-772-0255
kocheck.com

WARRANTY

- Kochek Co Inc. warrants to the original purchaser and all subsequent purchasers of the Kochek products that the product is free from defects in material and workmanship during a (5) five year period from the date of its sale by Kochek Co. Inc.
- Kochek Co. Inc.'s obligation under this warranty is specifically limited to replacing or repairing any product which is determined by our inspection to be in a defective condition attributed to our manufacture or design. If Kochek Co. Inc. determines the product is defective, we will repair or replace the product during the warranty period. The purchaser or beneficiary must notify Kochek Co. Inc. of any alleged defect within a reasonable time period after purchase.
- If we determine that the product is defective, then we will replace the product, repair the product or refund the purchased price, at Kochek Co. Inc.'s election.
- The warranty is a LIMITED WARRANTY. The original purchaser of the product and any subsequent purchaser of the product and any person who is an intended or unintended beneficiary of the product shall not be entitled to recover from Kochek Co. Inc. and consequential or incidental damages for injury to person and / or property resulting from any defective product manufactured or assembled by us. It is agreed that the price stated and paid for the product is in part consideration for limiting Kochek Co. Inc.'s liability.
- This is a limited Expressed Warranty Only. Kochek Co. Inc. EXPRESSLY DISCLAIMS WITH RESPECT TO THE PRODUCT ALL IMPLIED WARRANTIES OF **MERCHANTABILITY** AND ALL IMPLIED WARRANTIES OF **FITNESS FOR A PARTICULAR PURPOSE**.
- There are NO WARRANTIES of any nature made by Kochek Co. Inc. beyond that which is stated in this Warranty.

SAFETY

Meaning of SAFETY WORDS



DANGER

Indicates an imminently hazardous situation which, if not avoided, will result in death or serious injury.



WARNING

Indicates a potentially hazardous situation which, if not avoided, could result in death or serious injury.



CAUTION

Indicates a potentially hazardous situation which, if not avoided, may result in minor or moderate injury.

SAFETY and CAUTIONS



DANGER

This equipment is to be used by trained fire fighting personnel only. Failure to obtain proper training may result in severe injury or death.



DANGER

Do not exceed maximum operating pressure. Exceeding the maximum rated pressure for this appliance may cause malfunction, or failure resulting in severe injury or death.



DANGER

Failure of fittings and hoses can result in injury. Use caution not to exceed hose pressures as stated in NFPA 1961 for the type of hose being used.



DANGER

Make sure all connections are secure and complete. Failure to ensure proper connection may result in leaks or cause the devices to become disconnected under pressure resulting in injury or death.



DANGER

Open and close all valves slowly. Failure to operate valves slowly may cause water hammer, which may result in damage or failure of hose, coupling devices, and appliances leading to injury or death.



WARNING

Do not use if damaged. Damage to product may cause malfunction or failure. Remove from service until unit can be repaired.



WARNING

Check for damaged or worn coupling connections. Damage or worn connections may become disconnected under pressure. Remove from service to be repaired by a Kocheck Co. Inc. certified repair facility.



CAUTION

For use with fresh or salt water, with or without fire fighting foam.



WARNING

Altering of this device may reduce its operating effectiveness, or safety. Do not alter or change in any way from its intended design.

OVERVIEW

STYLE	EXTENSION	HEIGHT	WIDTH	WEIGHT
09K SMALL STRAIGHT GATE	5 1/4"	13"	5 1/4"	4.5 lb.

Operating pressures

- Normal operating pressure up to 300 PSI. Tested burst pressure hydrostatic test per NFPA1965.

Construction

- Aluminum body and anodized aluminum gate.

OPERATION



Attach the Gate Valve securely to the water source, fire truck or hydrant.



This valve is intended to be attached to a fixed object such as a hydrant, stand pipe or a vehicle. It is not intended and should not be used as a connection between two hoses. If the valve is not attached to a fixed object it may move violently which could cause injury or death.

Make sure all connections are secure and complete. Failure to ensure proper connection may result in leaks or cause the device to become disconnected under pressure resulting in injury or death.



Ensure the valve is fully closed.



Attach hose line securely to the valve.



Attach hose line securely to water source or appliance/apparatus on the other end.



If the Gate Valve is attached to the water source or fire hydrant, slowly open the gate valve and fill the hose line with water. Avoid opening quickly as this may cause a water hammer and damage valves, hoses, apparatus and/or appliances resulting in equipment failure or injury.



When a long hose line is supplying water through the gate valve, open the valve slowly to bleed off trapped air in the hose line.



Open and close valves with your hands only. DO NOT use tools to assist in operation of the valves.



Valve should be fully open/closed with approx. 8 full turns on the control wheel, or crank handle.



Open and close valves fully, DO NOT regulate water or pressure with the valve.

OPERATION

- Slowly increase pressure in hose to desired operating pressure and desired water flow rates. Normal operating pressures are from 100 to 300 PSI.
- When operations are completed, shut down valve(s) completely.

 **WARNING**

Bleed off any excess pressure in hose lines before you attempt to disconnect any hose or apparatus and disconnect and drain hose lines.

 **DANGER**

If connected to the water supply, fire hydrant, or other source shut down supply completely and bleed off any excess pressure prior to disconnecting the gate valve. Attempting to disconnect the valve before pressure is relieved may result in serious injury.

 **WARNING**

After use, clean and inspect the valve for damage or malfunctioning parts. Repair or replace damaged parts or remove the valve from service until repairs can be made. The valve should be repaired by a Kochek Co. Inc. certified repair facility.

- Do not use if damaged. Damage to product may cause malfunction or failure. Remove from service until unit can be repaired.
- Check for damaged or worn coupling connections. Damaged or worn connections may become disconnected under pressure. Remove from service and repair appropriate parts.

- Foam may be used with this appliance. Be sure to flush completely with fresh water after use. Some foam concentrates may leave residue that may cause corrosion or become sticky and interfere with the operation of internal parts and shorten the service life of this appliance.
- Salt water may be used with this appliance. Flush with large amounts of fresh water after use. Salt water may shorten the service life of this appliance due to corrosion.
- Flush with fresh clean water after use to remove dirt and debris. This is especially important if salt water or foam has been used in this appliance.

CARE AND MAINTENANCE

 **DANGER**

Inspect appliance for damage or malfunctioning parts routinely. If appliance is damaged or not functioning properly, repair or remove appliance from service until repairs can be made.

 **WARNING**

Check gaskets and swivels to ensure proper operation. Repair or replace as needed. If repairs cannot be made immediately, remove from service until repaired by a Kochek Co. Inc. certified technician.

Do not use if damaged. Damage to product may cause malfunction or failure. Remove from service until unit can be repaired.

Check for damaged or worn coupling connections. Damaged or worn connections may become disconnected under pressure. Remove from service and repair appropriate parts.

 **WARNING**

- In case of leakage replace gaskets as needed.
- Check all screws and bolts to ensure they are securely tightened.
- Check connections for damaged threads, lugs or gaskets.

 **DANGER**

On any appliance with a non-threaded coupling, (i.e. Storz) check the locking device on coupling for damage and ensure proper operation. Make sure the coupling and the valve are clean, clear and free of damage. If locking device is malfunctioning, repair or replace the lock.

 **CAUTION**

Dirt and debris should be clear of the gate to allow full range of motion.

CARE AND MAINTENANCE



- Lubricate as necessary with Kochek Co. Inc. ST2 lubricant. ST2 is environmentally friendly containing NO grease.
- Using a lubricant other than the recommended lubricants may cause the O-rings to swell or degrade faster than expected. Do not use excessive amounts of lubricant, over lubricating may cause dirt to collect inside the valve.
- Use only recommended lubricant, improper lubricants may cause premature failure of O-rings and seals.
- Apply lubricant to the following points to ensure smooth operation:
 - Lightly lubricate the gate inside the valve.
 - Open and close the valve several times to ensure smooth operation and spread lubricant across the face of the gate.

09K PARTS LIST

Item	Description
09K-01	Handle
09K-02	Screw
09K-03	Nut
09K-04	Washer
09K-05	Handle Wheel
09K-06	Screw
09K-07	Stem
09K-08	O-Ring
09K-09	Ball
09K-10	Body
09K-11	Disc
09K-12	Plate
09K-13	Screw
09K-14	O-Ring
09K-15	Adapter
09K-16	Screw

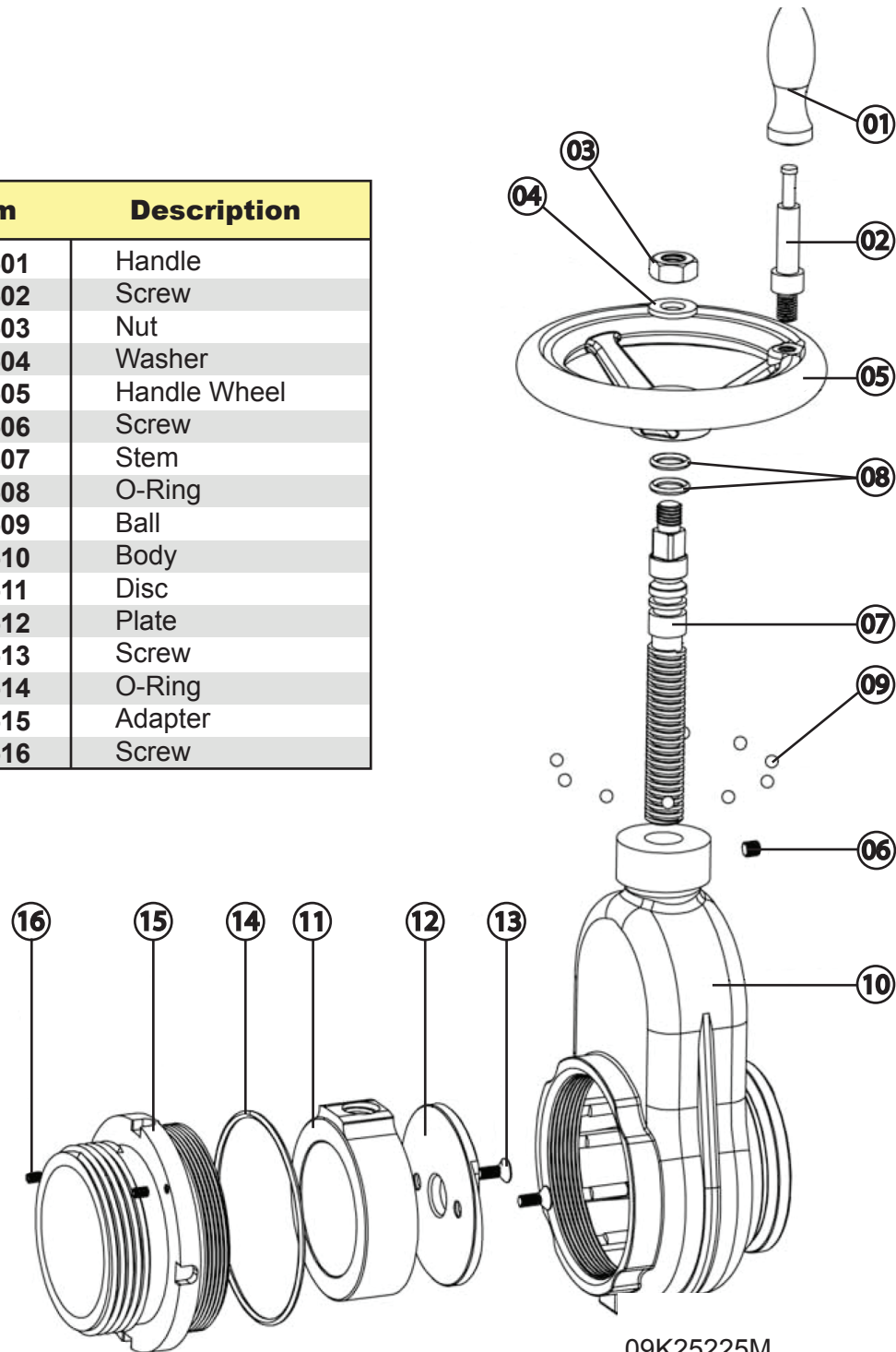

09K25225M